

## ■ Features

- ◆ High output power of 300W
- ◆ 200μm/0.22NA multimode optical fiber
- ◆ Center wavelength 808±7nm

## ■ Applications

- ◆ Fiber laser pumping
- ◆ Laser heating
- ◆ Laser welding
- ◆ Laser illumination

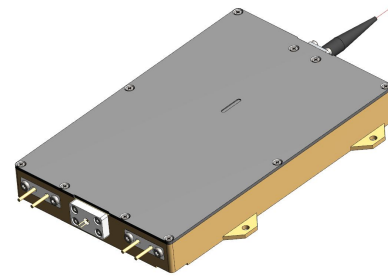

## Outline Dimension (mm)

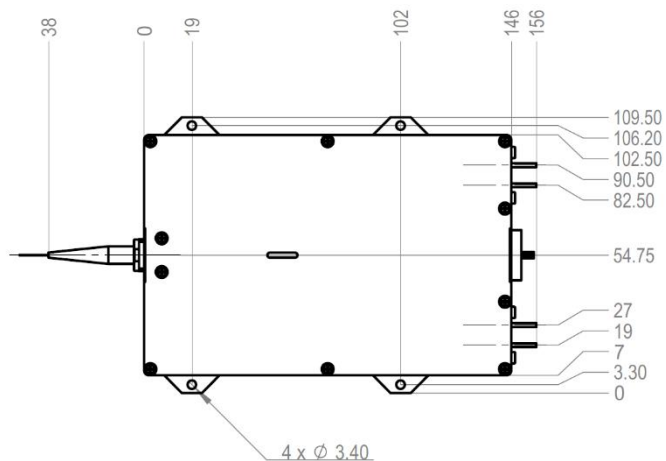
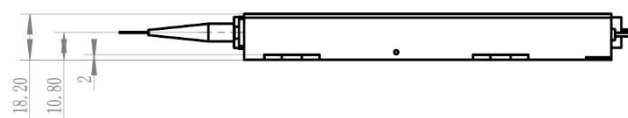

Pin-out Assignment	
Pin	Function
1	LD+
2	LD-
3	LD+
4	LD-
5	
6	
7	
8	

## Typical Device Performance

	Min	Typical	Max	Unit
<b>Optical</b>				
CW Output Power	300			W
Center Wavelength	803	808	813	nm
Spectral Width (FWHM)		7		nm
Wavelength Shift with Temperature		0.3		nm / °C
<b>Electrical</b>				
Threshold Current		1.3		A
Operating Current		13		A
Operating Voltage		31*2		V
Slope Efficiency		25.5		W / A
Power Conversion Efficiency		40		%
<b>Mechanical</b>				
Fiber Core Diameter		200		μm
Fiber Cladding Diameter		220		μm
Fiber Buffer Diameter		900		μm
Numerical Aperture		0.22		-
Fiber Length		2		m
Fiber Connector		HPSMA905		-

\* Customized fiber and connector available.

## Absolute Ratings

	Min	Max	Unit
Operating Temperature	0	40	°C
Operating Relative Humidity	20	60	%
Cooling Mode	thermal conduction		
Storage Temperature	-20	60	°C
Storage Relative Humidity	20	80	%
Lead Soldering Temperature (10 s max)	260	300	°C

\* Measuring specifications.

All figures in this specification are measured by CNI's method and may contain measurement deviations.

The above specifications are for reference purpose only and subjected to change without prior notice.

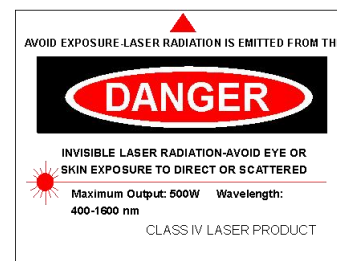

Changchun New Industries Optoelectronics Tech. Co., Ltd  
<http://www.cnilaser.com>

### ◆ CONTACT

No.888, JinHu Road, High-tech zone, Changchun  
 130103, R.P. China

Phone: 0086-431-85603799

Fax: 0086-431-87020258