



LDM-878.6-25

Typical Device Performance (25°C)

Optical	Unit	Typical Value
CW Output Power	W	25
Center Wavelength	nm	878.6±0.5
Spectral Width (90% of Power)	nm	<0.5
Wavelength Shift with Temperature	nm / °C	0.02
Wavelength Shift with Current	nm / A	0.05
Feedback Protection (1030-1100nm)	dB	>40
Electrical		
Threshold Current	A	0.7
Operating Current	A	8
Operating Voltage	V	7.5
Slope Efficiency	W / A	3.4
Power Conversion Efficiency	%	46
Fiber*		
Fiber Core Diameter	μm	200
Fiber Cladding Diameter	μm	220
Fiber Buffer Diameter	μm	500
Numerical Aperture	-	0.22
Fiber Length	m	1.0
Fiber optic connector	-	SMA905

* Customized fiber and connector available.

Absolute Ratings

	Unit	Min	Max
Operating Temperature	°C	10	40
Operating Relative Humidity	%	-	75
Storage Temperature	°C	-20	80
Storage Relative Humidity	%	-	90
Lead Soldering Temperature, 10s max	°C	-	250

Addr: No.888 Jinhu Road High-tech Zone, Changchun 130103, P.R.China

Contact: sales@cnlaser.com International Tel: +86-431-85603799 Fax: +86-431-87020258

Characteristics of 878.6nm-25W laser diode module (25°C)

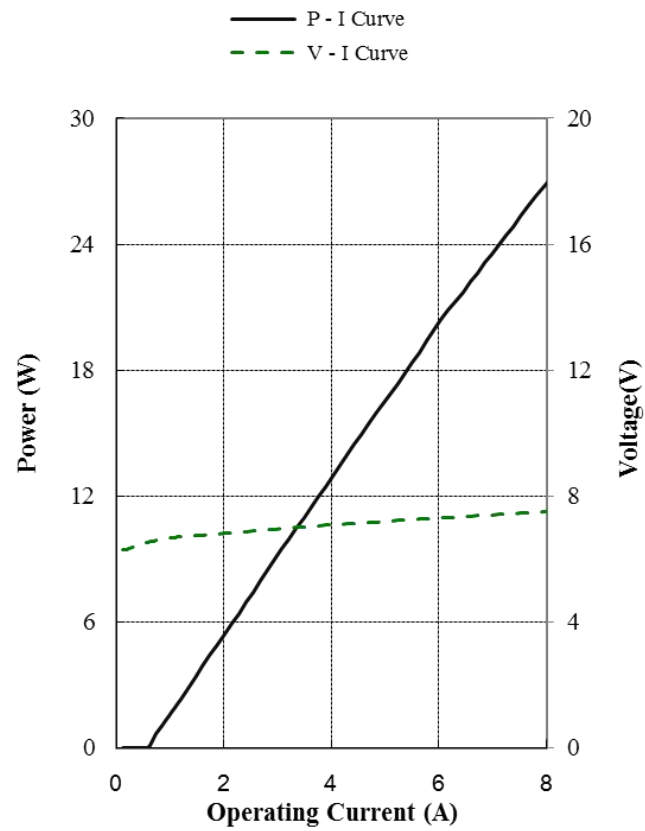

Typical spectrum of 878.6nm-25W laser diode module (25°C)

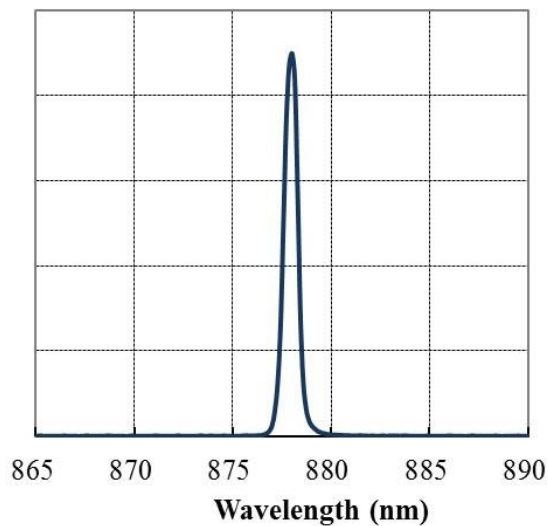

Addr: No.888 Jinhua Road High-tech Zone, Changchun 130103, P.R.China

Contact: sales@cnlaser.com International Tel: +86-431-85603799 Fax: +86-431-87020258

Package Dimensions (mm)

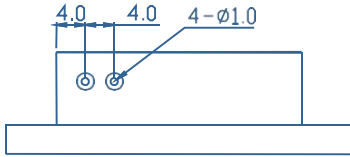

Pin-Out Assignment	
Pin	Function
1	LD(+)
2	LD(-)

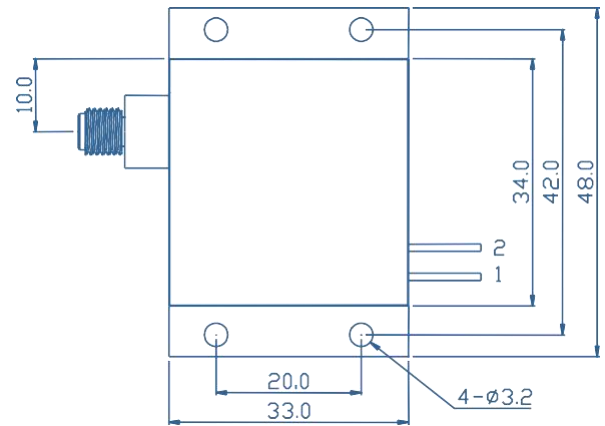

Addr: No.888 Jinhua Road High-tech Zone, Changchun 130103, P.R.China

Contact: sales@cnilaser.com International Tel: +86-431-85603799 Fax: +86-431-87020258