



# LDM-915-80

## Typical Device Performance (25°C)

Optical	Unit	Typical Value
CW Output Power	W	80
Center Wavelength	nm	915±10
Spectral Width (90% of Power)	nm	<6.0
Wavelength Shift with Temperature	nm / °C	0.3
Feedback Protection (1030-1100nm)	dB	>40
Light within 0.16NA	-	95%
Electrical		
Threshold Current	A	0.7
Operating Current	A	11.7
Operating Voltage	V	13.5
Slope Efficiency	W / A	7.4
Power Conversion Efficiency	%	51
Fiber*		
Fiber Core Diameter	μm	105
Fiber Cladding Diameter	μm	125
Fiber Buffer Diameter	μm	250
Numerical Aperture	-	0.22
Fiber Length	m	1.0
Fiber connector	-	-

\* Customized fiber and connector available.

## Absolute Ratings

	Unit	Min	Max
Operating Temperature	°C	10	40
Operating Relative Humidity	%	-	75
Storage Temperature	°C	-20	80
Storage Relative Humidity	%	-	90
Lead Soldering Temperature, 10s max	°C	-	250

Addr: No.888 Jinhua Road High-tech Zone, Changchun 130103, P.R.China

Contact: sales@cnilaser.com International Tel: +86-431-85603799 Fax: +86-431-87020258

## Characteristics of 915nm-80W laser diode module (25°C)

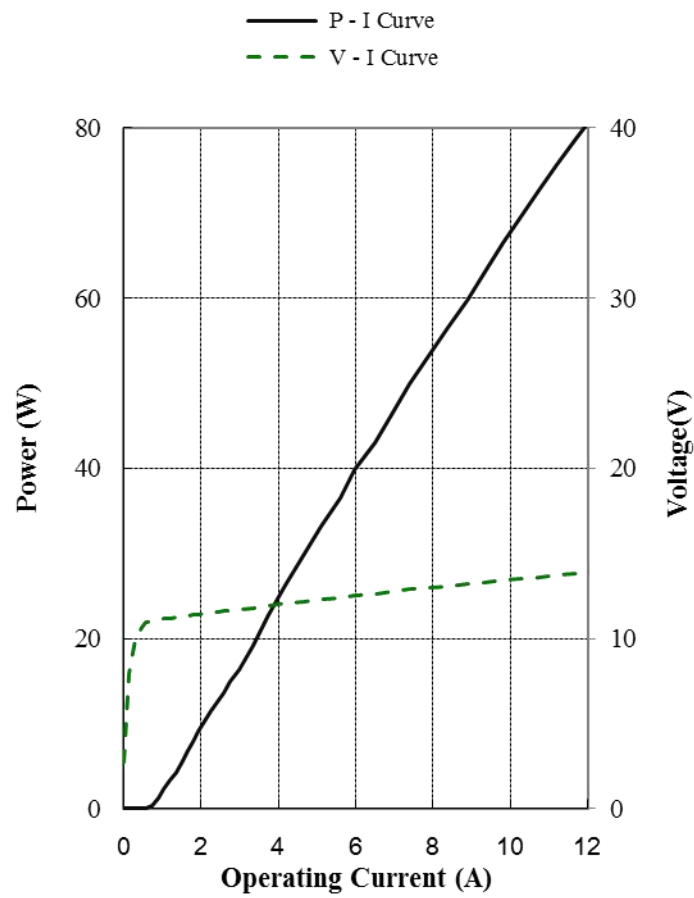

## Typical spectrum of 915nm-80W laser diode module (25°C)

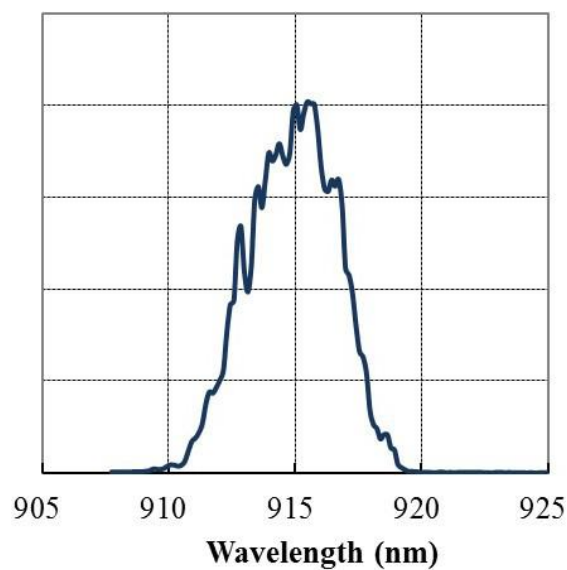

## Package Dimensions (mm)

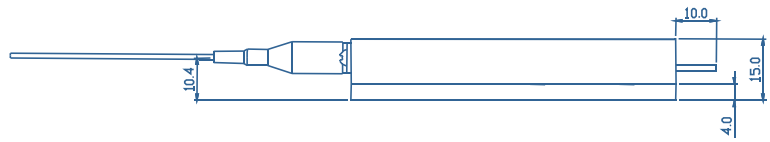
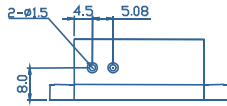

Pin-Out Assignment	
Pin	Function
1	LD (+)
2	LD (-)

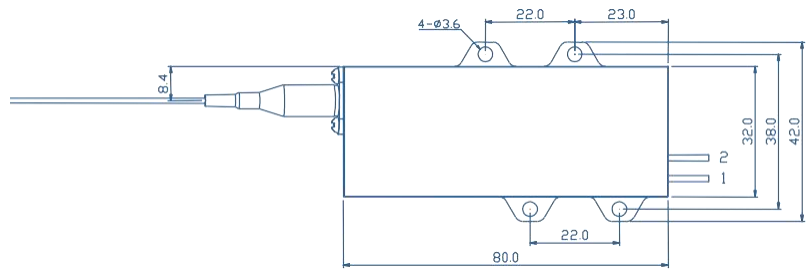

Addr: No.888 Jinhua Road High-tech Zone, Changchun 130103, P.R.China

Contact: sales@cnlaser.com International Tel: +86-431-85603799 Fax: +86-431-87020258