



LDM-976-60

Typical Device Performance (25°C)

Optical	Unit	Typical Value
CW Output Power	W	60
Center Wavelength	nm	976±0.5
Spectral Width (90% of Power)	nm	<0.5
Wavelength Shift with Temperature	nm / °C	0.02
Wavelength Shift with Current	nm / A	0.05
Feedback Protection (1030-1100nm)	dB	>30
Light within 0.15NA	-	95%
Electrical		
Threshold Current	A	0.6
Operating Current	A	9.2
Operating Voltage	V	13.0
Slope Efficiency	W / A	7
Power Conversion Efficiency	%	50
Fiber*		
Fiber Core Diameter	μm	105
Fiber Cladding Diameter	μm	125
Fiber Buffer Diameter	μm	250
Numerical Aperture	-	0.22
Fiber Length	m	2.0
Fiber connector	-	-

* Customized fiber and connector available.

Absolute Ratings

	Unit	Min	Max
Operating Temperature	°C	10	40
Operating Relative Humidity	%	-	75
Storage Temperature	°C	-20	80
Storage Relative Humidity	%	-	90
Lead Soldering Temperature, 10s max	°C	-	250

Addr: No.888 Jinhu Road High-tech Zone, Changchun 130103, P.R.China

Contact: sales@cnilaser.com International Tel: +86-431-85603799 Fax: +86-431-87020258

Characteristics of 976nm-60W laser diode module (25°C)

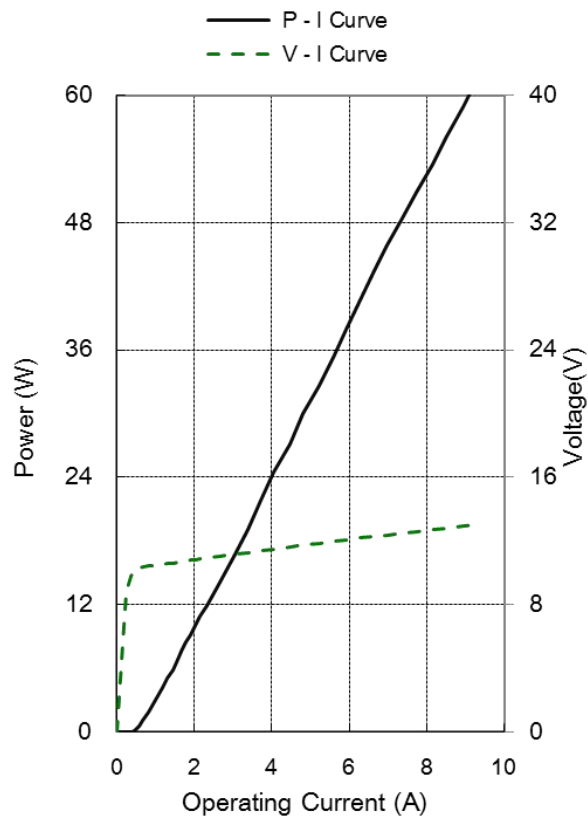

Typical spectrum of 976nm-60W laser diode module (25°C)

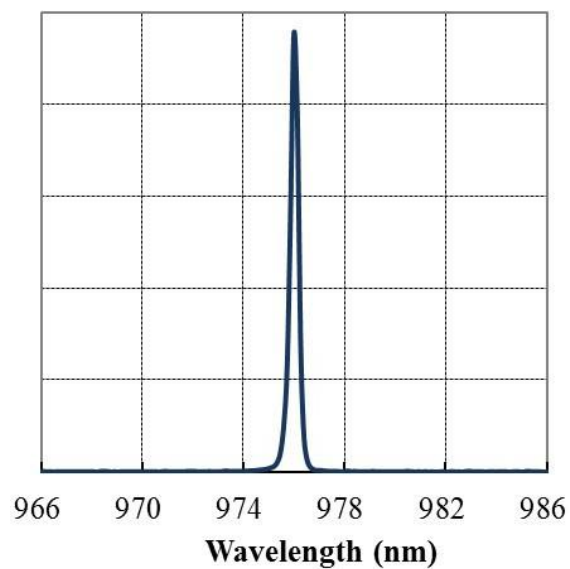

Addr: No.888 Jinhua Road High-tech Zone, Changchun 130103, P.R.China

Contact: sales@cnlaser.com International Tel: +86-431-85603799 Fax: +86-431-87020258

Package Dimensions (mm)

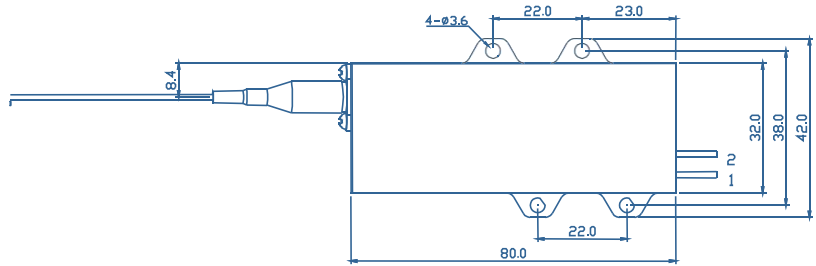
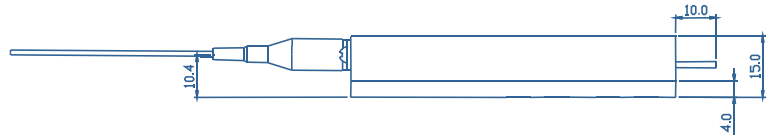
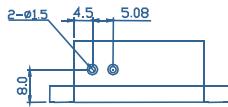

Pin-Out Assignment	
Pin	Function
1	LD (+)
2	LD (-)



Addr: No.888 Jinhua Road High-tech Zone, Changchun 130103, P.R.China

Contact: sales@cnilaser.com International Tel: +86-431-85603799 Fax: +86-431-87020258