

OEM-S-532/1~300mW



LD PUMPED ALL-SOLID-STATE
GREEN LASER

All solid state 532nm green laser is made features of high output power stability, good beam profile, ultra compact, small size, wide operating temperature, good sealing, long lifetime, low cost and easy operating, working under the pressure of 0.02kPa, which is widely used in collimation, laser medical treatment, scientific experiment, optical instrument, laser display, laser lighting show, etc.



SPECIFICATIONS

Wavelength (nm)	532±1	
Operating mode	CW	
Output power (mW)	>1,5,10,20,...,200	>200,...,300
Power stability (rms, over 4 hours)	<1%,<3%,<5%	<3%,<5%
Transverse mode	TEM ₀₀	
M ² factor	<1.2	
Beam diameter at the aperture(1/e ² ,mm)	0.7±0.05	
Beam divergence, full angle (mrad)	<1.5	
Polarization ratio	>100:1 Horizontal±5 degree (Vertical Optional)	
Pointing stability after warm-up (mrad)	<0.05	
Pointing stability Over Temp. (μrad/°C)	<8	
Warm-up time (minutes)	<5	
Beam height from base plate (mm)	19	
Power Consumption(W)	<30	
Shock Tolerance(6ms)	7g laterally,15g vertically	
IP Rating	IP65	
Power supply(90-264VAC or 5VDC)	PSU-III-OEM-97	
Operating temperature (°C)	10-35	
Max. Heat Dissipation of Head(W)	4W@25°C	
Modulation	TTL on/off, 1Hz-1KHz, 1KHz-10KHz, 10KHz-30KHz; and Analog modulation option	
Expected lifetime (hours)	10000	
Warranty	1 year	



OEM-S-532

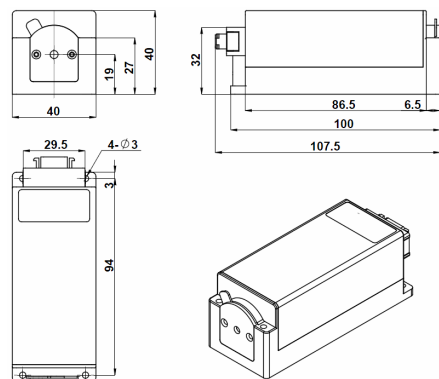

100 (L) × 40 (W) × 40 (H) mm³, 0.41kg

PSU-III-OEM-97

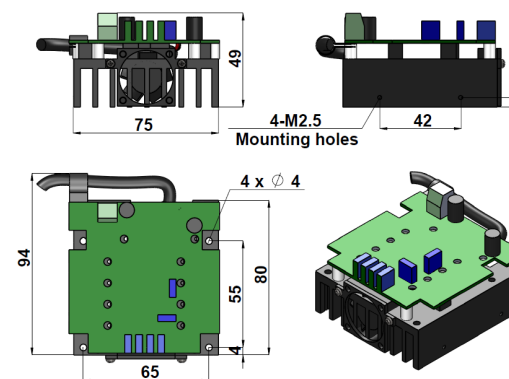

94(L) × 75(W) × 49(H)mm³, 0.23kg