



1550nm Laser Diode

CHANGCHUN NEW INDUSTRIES OPTOELECTRONICS TECH. CO., LTD.

■ Features

- Output Power: 20mW (CW)
- Efficient Quantum Well Structure
- Standard TO-18 Package

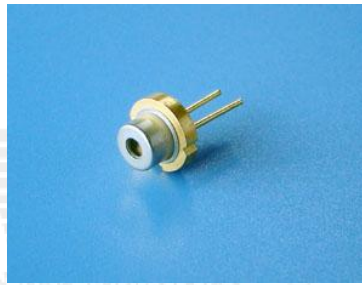

■ Absolute Maximum Ratings

(Tc=25°C)

| Item | Symbol | Absolute Maximum Ratings | Unit |
|----------------------------|---------|--------------------------|------|
| Optical Output Power | Po | 20 | mW |
| LD Reverse Voltage | Vr (LD) | 2 | V |
| Storage Temperature | Tstg | -40~85 | °C |
| Operating Case Temperature | Tc | -40~40 | °C |

■ Initial Electrical/Optical Characteristics

(Tc=25°C)

| Item | Symbol | Typ. | Unit |
|------------------------------------|------------------|--------|-------|
| Optical Output | Po | 20 | mW |
| Peak Wavelength* | λ_p | 1550±5 | nm |
| Threshold Current | Ith | ≤0.03 | A |
| Operating Current | Iop | ≤0.1 | A |
| Slope Efficiency | η | ≥0.15 | W/A |
| Operating Voltage | Vop | ≤1.8 | V |
| Horizontal Beam Divergence | $\theta_{//}$ | ≤25 | deg. |
| Vertical Beam Divergence | θ_{\perp} | ≤38 | deg. |
| Spectrum FWHM | | <0.3 | |
| Wavelength Temperature Coefficient | | 0.2 | nm/°C |
| Polarization | | TE | |

* Measuring specifications.

All figures in this specification are measured by CNI's method and may contain measurement deviations.

The above specifications are for reference purpose only and subjected to change without prior notice.

Outline Dimension

TO-18 Package

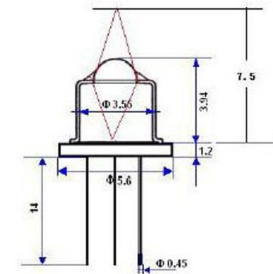

(Unit: mm)

Pin Connection

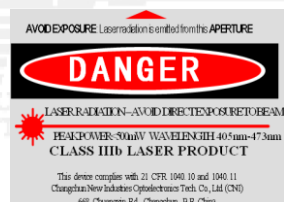
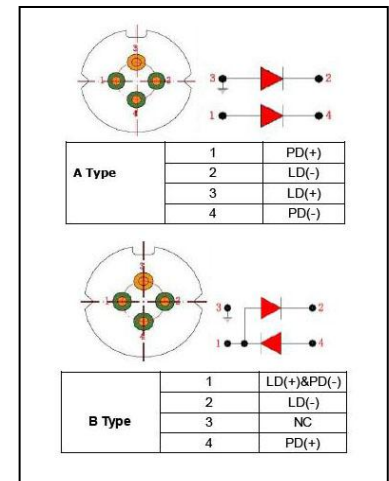

Changchun New Industries Optoelectronics Tech. Co., Ltd

<http://www.cnilaser.com>

◆ CONTACT

No.888, Jinhu Road, High-tech zone, Changchun 130103, China

Phone: 0086-431-87033597

Fax: 0086-431-87033597