



EO-355-PS/1-6W

HIGH POWER DIODE PUMPED ALL-SOLID-STATE MODE LOCKED LASER

High average power diode pumped all solid state laser at 355nm has the features of short pulse duration, high repetition rate and high average power, which is widely used in laser medical treatment, industrial processing, physics experiment, scientific research, and so on.



SPECIFICATIONS

Wavelength (nm)	355±1
Operating mode	Pulsed
Average power (W) ¹	1-6@1MHz
Single pulse energy (uJ)	1-40@200kHz
Power stability (rms, 4 hours ±3°C)	<5%
Pulse duration (ps)	<15
M ²	≤1.5
Pointing stability over temperature (urad/°C)	<50
Beam Ellipticity	>85%
Polarization	100:1
Beam diameter (mm)	1.5±0.5
Beam divergence, full angle (mrad)	≤3
Repetition frequency (kHz) ²	1-1000
Control mode	Gate/burst/INT control
Beam height from base plate (mm)	90
Cooled method	Water cooled
Warm-up time (minutes)	<15
Operating temperature (°C)	15-30
Relative humidity	<60%
Power supply (110/220VAC)	PSU-EO-PS
Expected lifetime (hours)	>10000



LASER HEAD

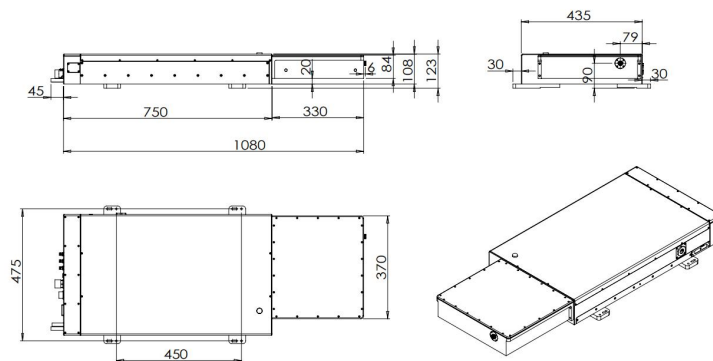

1125(L)×495(W)×108(H) mm³, 60kg

POWER SUPPLY

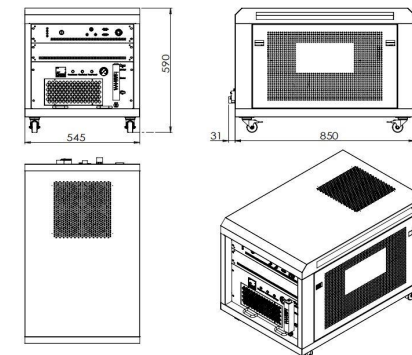

881(L)×545(W)×590(H) mm³, 105kg

1 The output power and energy varies with different frequency; Output power 10W and 15W can be customized.

2 One fixed value between 1-1000Hz; Repetition rate 1-1000Hz variable and other frequency can be customized.