

PS-D-355-Water/1-2000mW



PICOSECOND PULSED LASER

Picosecond pulsed laser is characterized by short pulse duration and good beam quality, which is used in glass marking, sapphire marking, ceramic cutting, semiconductor cutting, solar panel coating, film scribing, etc.



SPECIFICATIONS

Wavelength (nm)	355±1
Output power (mW)	1-2000@1MHz
Rep.rate (MHz) ¹	0.4-2
Pulse duration (ps) ²	~10
Power stability (rms, 4 hours ± 3°C)	<2%, <1%
Transverse mode	TEM ₀₀
Beam Circularity (%) ³	>90
Beam divergence, full angle (mrad)	<2
M ²	<1.2
Beam diameter at the aperture (1/e ² , mm)	~2
Polarization ratio	>100:1 Horizontal (Vertical optional)
Beam height from base plate (mm)	96
Warm-up time (minutes)	≥ 30
Operating temperature (°C)	20-30
Cooling method	Water cooled
Operating voltage (VDC)	36V/40A
Expected lifetime (hours)	>10000



LASER HEAD (Driver Integrated)

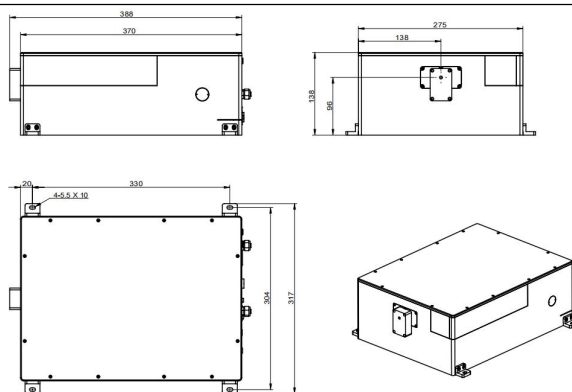

388 (L) × 317 (W) × 138 (H) mm³, 19.3kg

POWER SUPPLY (100-240VAC)

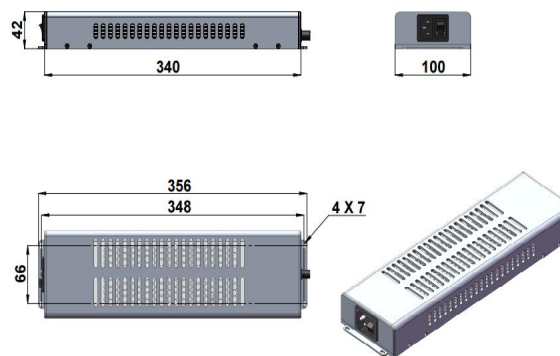

356(L) × 100 (W) × 42 (H) mm³, 2.4kg

WATER CHILLER (WCH-580)

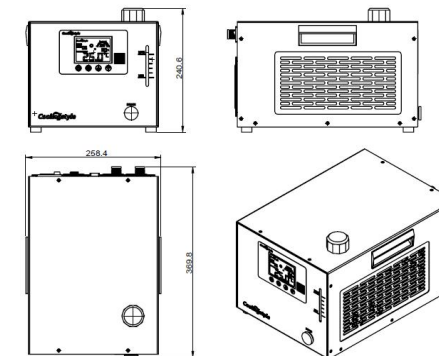

369.8 (L) × 258.4 (W) × 240.6 (H) mm³, 10.5 kg

- 1 Other rep.rate range available on request.
- 2 Other pulse width available on request.
- 3 Better beam circularity available on request.